



# SDRH6D28-6D38 SERIES

## Magnetic Shielded SMD Power Inductors

### FEATURES

- Magnetically Shielded Structure
- Low DC Resistance
- Large current up to 3.2A
- Excellent Mechanical Strength
- High Reliability and Excellent Solderability
- Low and square Profile
- High heat resistance

### OPTIONS

- Packaging: Tape & Reel is standard (Qty:2000pcs)
- Bulk packaging available for smaller quantities
- Tolerance: 10% and 5% is standard
- Lower tolerances available

### APPLICATIONS

- VCRs, Notebook, DC/DC Converters
- Video Digital Cameras
- Communication System
- Automotive Systems Power supplier
- LCD PDP Televisions
- Hard Disk Drives, Topset, XDSL
- Network Systems
- Computer Peripheral Equipment

Part Number	L μH	Test Freq KHz	DCR Ohm Max	IDC max. A	Part Number	L μH	Test Freq KHz	DCR Ohm Max	IDC max. A
SDRH6D28-3R0N	3.0	10	24	3.00	SDRH6D38-3R3N	3.3	10	20	3.20
SDRH6D28-3R9N	3.9	10	27	2.60	SDRH6D38-5RON	5.0	10	24	2.60
SDRH6D28-5RON	5.0	10	31	2.40	SDRH6D38-6R2N	6.2	10	27	2.30
SDRH6D28-6RON	6.0	10	35	2.25	SDRH6D38-7R4N	7.4	10	31	2.10
SDRH6D28-7R3N	7.3	10	54	2.10	SDRH6D38-8R7N	8.7	10	34	2.00
SDRH6D28-8R6N	8.6	10	58	1.85	SDRH6D38-100N	10	10	44	1.80
SDRH6D28-100N	10	10	65	1.70	SDRH6D38-120N	12	10	53	1.70
SDRH6D28-120N	12	10	70	1.55	SDRH6D38-150N	15	10	57	1.45
SDRH6D28-150N	15	10	84	1.40	SDRH6D38-180N	18	10	92	1.40
SDRH6D28-180N	18	10	95	1.32	SDRH6D38-220N	22	10	96	1.20
SDRH6D28-220N	22	10	128	1.20	SDRH6D38-270N	27	10	109	1.10
SDRH6D28-270N	27	10	142	1.05	SDRH6D38-330N	33	10	124	1.00
SDRH6D28-330N	33	10	165	0.97	SDRH6D38-390N	39	10	138	0.95
SDRH6D28-390N	39	10	210	0.86	SDRH6D38-470N	47	10	155	0.85
SDRH6D28-470N	47	10	238	0.80	SDRH6D38-560N	56	10	202	0.75
SDRH6D28-560N	56	10	277	0.73	SDRH6D38-680N	68	10	234	0.70
SDRH6D28-680N	68	10	304	0.65	SDRH6D38-820N	82	10	324	0.62
SDRH6D28-820N	82	10	390	0.60	SDRH6D38-101N	100	10	358	0.58
SDRH6D28-101N	100	10	535	0.54					

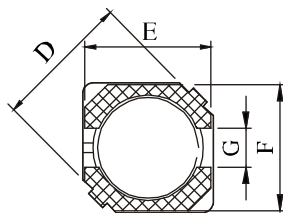
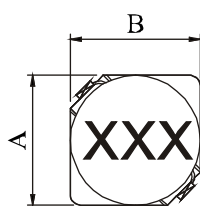

### LAND PATTERNS

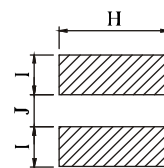

### CONSTRUCTION



- Inductor Testing: HP4284A (Equivalent acceptable)
  - DCR: QuadTech 1880 Milliohm meter
  - Q- HP4342A – SRF-HP4191A
  - IDCMax current is decreased 10% against its initial value
  - Operating temperature: -40°C to +105°C
  - Storage Temperature: -40°C to +105°C
  - Solder methods: Vapor Phase, Infrared Reflow
  - Resistance to soldering heat: 260°C for 10 seconds
  - Solvent resistance: Conforms to MIL-STD-202E
  - Marking: Inductance & Tolerance
- Note: All specifications subject to change without notice.

### DIMENSIONS IN: mm

Part number	A	B	C	D	E	F	G	H	I	J
SDRH6D28	7.0Max	7.0Max	3.2Max	9.5Max	6.5	6.5	2.0	7.3	2.65	2.0
SDRH6D38	7.0Max	7.0Max	4.2Max	9.5Max	6.5	6.5	2.0	7.3	2.65	2.0