



# LGB112C-1315C SERIES

## Through Hole Radial Encapsulated Power Inductor

### FEATURES

- Plastic Housing
- Water Proof Structure Ferrite Core
- Excellent Mechanical Strength
- High Reliability

### OPTIONS

- Packaging: T&R Standart 2Kpcs
- Tolerance: 10% and 5% is standard
- Lower tolerances available.

### APPLICATIONS

- VCR, PDP, LCD, TV STB
- Automotive
- Computer Peripheral
- GPS, DC-DC Converter, XDSL
- E-Games
- Communication
- Household

Part Number	L μH	Test Freq KHz	DCR ohm Max.	IDC A Max.	Part Number	L μH	Test Freq KHz	DCR ohm Max.	IDC A Max.
LGB1112C-3R3M	3.3	1	0.01	5.9	LGB1315C-100M	10	1	0.02	5.1
LGB1112C-4R7M	4.7	1	0.02	4.8	LGB1315C-150M	15	1	0.03	4.5
LGB1112C-6R8M	6.8	1	0.02	4.6	LGB1315C-220M	22	1	0.04	4.2
LGB1112C-100M	10	1	0.03	3.7	LGB1315C-330M	33	1	0.04	3.7
LGB1112C-150M	15	1	0.03	3.4	LGB1315C-470M	47	1	0.05	3.4
LGB1112C-220M	22	1	0.04	2.9	LGB1315C-680M	68	1	0.07	3
LGB1112C-330M	33	1	0.06	2.3	LGB1315C-101K	100	1	0.1	2.5
LGB1112C-470M	47	1	0.08	2.1	LGB1315C-151K	150	1	0.14	2.1
LGB1112C-680M	68	1	0.13	1.6	LGB1315C-221K	220	1	0.2	1.7
LGB1112C-101K	100	1	0.16	1.4	LGB1315C-331K	330	1	0.3	1.4
LGB1112C-151K	150	1	0.26	1.1	LGB1315C-471K	470	1	0.43	1.1
LGB1112C-221K	220	1	0.33	1	LGB1315C-681K	680	1	0.61	1
LGB1112C-331K	330	1	0.52	0.8	LGB1315C-102K	1000	1	1	0.8
LGB1112C-471K	470	1	0.66	0.7	LGB1315C-152K	1500	1	1.3	0.7
LGB1112C-681K	680	1	1.1	0.6	LGB1315C-222K	2200	1	2	0.6
LGB1112C-102K	1000	1	1.4	0.5	LGB1315C-332K	3300	1	3.1	0.4
LGB1112C-152K	1500	1	2.4	0.4	LGB1315C-472K	4700	1	4.4	0.4
LGB1112C-222K	2200	1	3.2	0.3	LGB1315C-682K	6800	1	6.5	0.3
LGB1112C-332K	3300	1	4.9	0.3	LGB1315C-103K	10000	1	10	0.2
LGB1112C-472K	4700	1	7.6	0.2					
LGB1112C-682K	6800	1	9.8	0.2					
LGB1112C-103K	10000	1	18	0.1					
LGB1112C-153K	15000	1	24	0.1					

Note:1. K= ± 10%,M= ± 20%,N= ± 30%

- IDC Max:Determined when superimposed
  - Testing: (Equivalent acceptable) Inductance:HP4284A  
RDC:QuadTech 1880 Milliohmeter  
Q- HP4342A – SRF-HP4191A  
DC current is decreased 10% against its initial value
  - Operating temperature: -40°C to +105°C
  - Storage Temperature: -40°C to +105°C
  - Solder methods: Vapor Phase,Infrared Reflow
  - Resistance to soldering heat:260°C for 10 seconds
  - Solvent resistance: Conforms to MIL-STD-202E
  - Marking: Inductance & Tolerance
- Note:All specifications subject to change without notice.

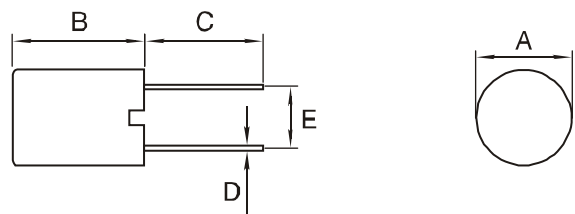

DIMENSIONS IN:mm

Part number	A	B	C	D	E
LGB1112C	11.5Max	12.5Max	5.0Min	0.6	5.0
LGB1315C	14.0Max	17.0Max	5.0Min	0.6	5.0