



CM09-10 SERIES

SMD Common Mode Choke

FEATURES

- LCP Base
- High Frequency Design
- Excellent Mechanical Strength
- Excellent Solderability
- High Reliability
- Low Profile

OPTIONS

- Packaging:Tape & Reel is standard (Qty:2000pcs)
- Bulk packaging available for smaller quantities
- Tolerance:10% and 5% is standard
- Lower tolerances available

APPLICATIONS

- Datalline Noise Suppression
- Video Cameras
- Communication System
- Automotive Systems
- Liquid Crystal Televisions
- Hard Disk Drives
- Network Systems
- Computer Peripheral Equipment

Part Number	Insertion Loss(dB)				DCR Ohm max.	IDC A max.	Impedance Typ.	Wistanding Voltage CH-901
	50MHz	100MHz	300MHz	500MHz				
CM 09-1394A	2.8 ± 2.0	7.3 ± 2.5	12.0 ± 3.0	14.0 ± 3.0	0.3	0.65	2200@100MHz	50VDC
CM 10-121	1.3 ± 0.5	4.0 ± 1.5	8.0 ± 2.0	11.0 ± 3.0	0.3	0.65	1200@100MHz	100VAC
CM 10-151	2.5 ± 1.0	3.0 ± 1.5	4.0 ± 2.0	5.0 ± 3.0	0.3	0.3	1500@100MHz	100VAC
CM 10-161	3.0 ± 1.0	8.0 ± 2.0	13.0 ± 2.5	15.0 ± 3.0	0.3	0.3	1600@100MHz	100VAC
CM 10-221	2.0 ± 1.0	6.0 ± 2.0	12.0 ± 2.5	14.0 ± 3.0	0.12	0.65	2200 @ 100MHz	100VAC

DIMENSIONS IN:mm

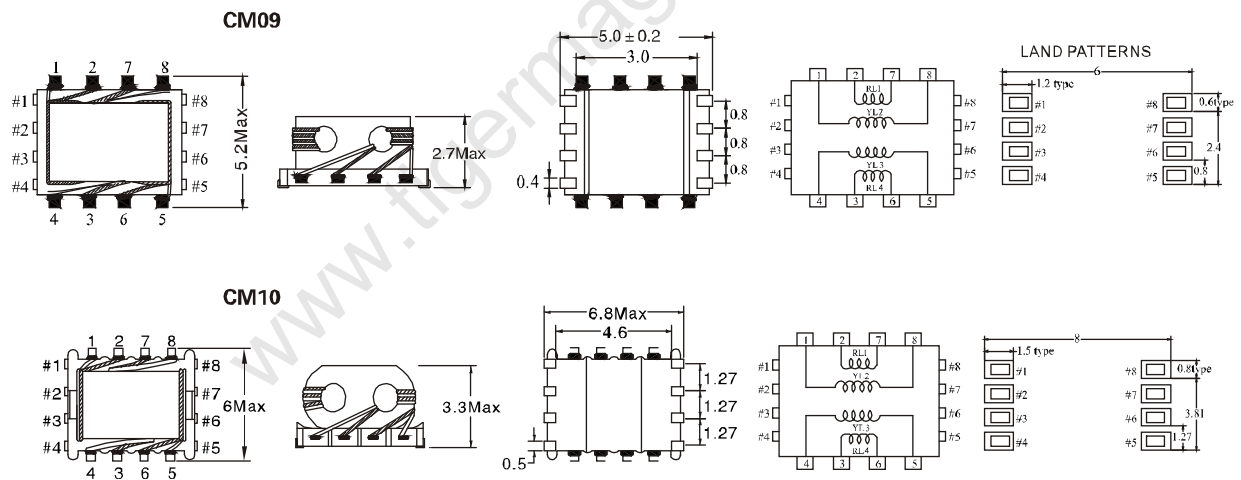

- Inductance Testing: 1KHz 1V HP4284A
- Z test with HP4191A or HP4395A
- RDC:QuadTech 1880 Milliohmeter
- Operating temperature: -40°C to +105°C
- Storage Temperature: -40°C to +105°C
- Resistance to soldering heat:260°C for 10 seconds
- Marking: Part number and date code

Note:All specifications subject to change without notice.