

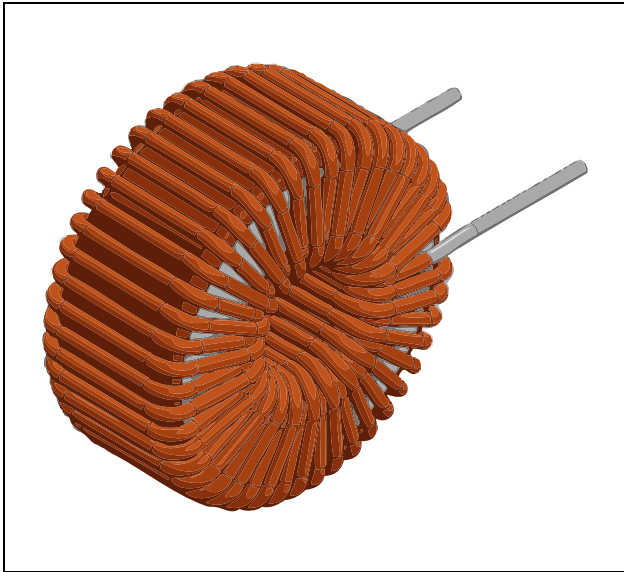

TG184014 Toroidal Inductor for Gate Driver EMI



FEATURES

- High Reliability
- Low Tolerance
- Bulk / Tray Package

APPLICATION

- Gate Drivers
- EMI Filters
- GaN(Gallium Nitride) / SiC (Silicon Carbide) FETs

Inductance	Pin 1-2	260 μ H
Tolerance		$\pm 10\%$ @ 10KHz, 0.1V
Rdc	Pin 1-2	38mOhm Max.
Hipot Test	Pin 1-2	1000VAC for 1sec. @1mA

